



 3  2  2  D

Shirley Drive, St. Leonards-On-Sea, TN37 7JW

£1,545 Per Calendar Month



Oliver & Bailey

01424 834000 | 01424 533 555

Info@oliverbaileylettings.co.uk
www.oliverbaileylettings.co.uk

Porch

Entrance Hall

Living Room

16'4" x 11'10" (4.98m x 3.61m)

Dining Room

14'0" x 8'11" (4.27m x 2.74m)

Ground Floor Shower Room

Kitchen

14'9" x 9'3" (4.50m x 2.82m)

First Floor Landing

Bedroom One

11'1" x 8'9" (3.38m x 2.67m)

Bedroom Two

12'2" x 9'8" (3.71m x 2.95m)

Bedroom Three

9'4" x 6'0" (2.87m x 1.85m)

Bathroom

Garage/ Store Room

Garden



Furnished Options: Unfurnished

Council Tax Band: C

Available Date: 13th March 2026

**Oliver
& Bailey**

THREE BEDROOM SEMI-DETACHED HOUSE WITH GARAGE ... Call Georgia or Robyn to view this well presented three bedroom family home.

Located within a popular residential road within St Leonards on Sea, the property is within walking distance to the Conquest Hospital, bus routes to Hastings Town Centre and Alexandra Park.

The property offers bright accommodation throughout and comprises a spacious living room / diner, down stairs shower room, modern fitted kitchen with integrated oven and hob. There are three good sized bedrooms and bathroom with shower over bath. Externally the property offers a low-maintenance rear garden.

Further benefits to the property are gas central heating, double glazing and driveway parking.

FLOORPLAN

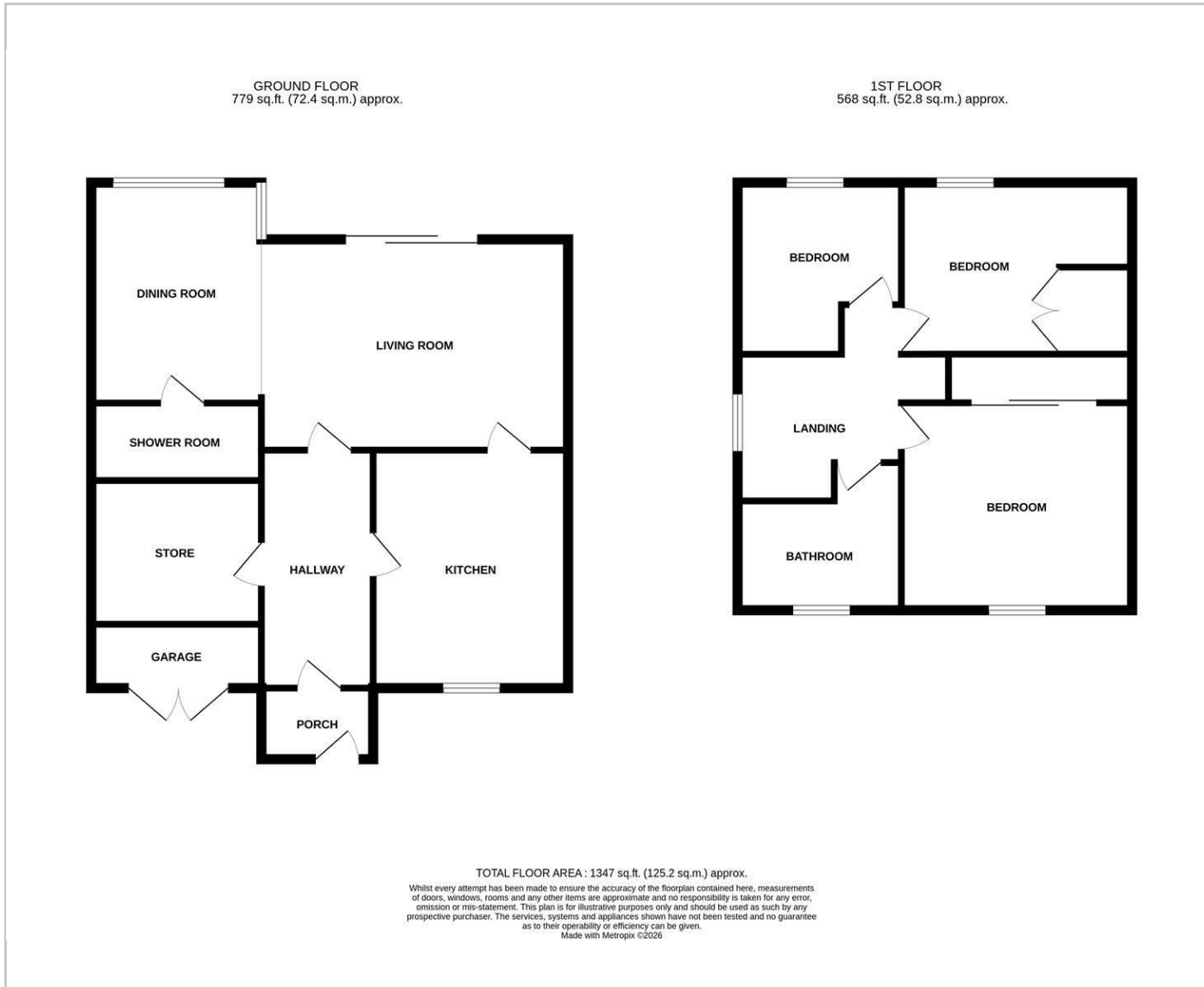

AREA MAP

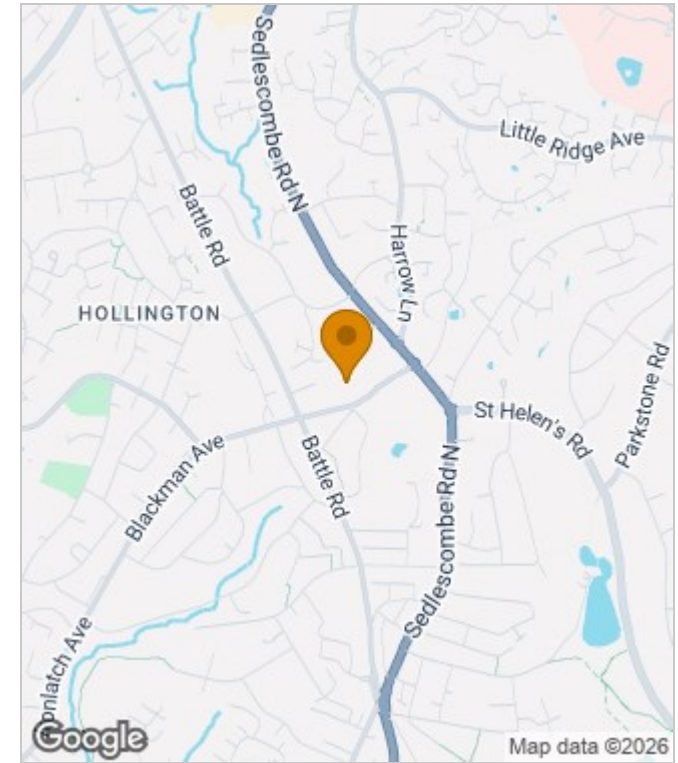

Energy Efficiency Rating		Current	Potential
Very energy efficient - lower running costs			
(92 plus) A			
(81-91) B			
(69-80) C			
(55-68) D			
(39-54) E			
(21-38) F			
(1-20) G			
Not energy efficient - higher running costs			
England & Wales		EU Directive 2002/91/EC	

Environmental Impact (CO ₂) Rating		Current	Potential
Very environmentally friendly - lower CO ₂ emissions			
(92 plus) A			
(81-91) B			
(69-80) C			
(55-68) D			
(39-54) E			
(21-38) F			
(1-20) G			
Not environmentally friendly - higher CO ₂ emissions			
England & Wales		EU Directive 2002/91/EC	

These particulars, whilst believed to be accurate are set out as a general outline only for guidance and do not constitute any part of an offer or contract. Intending purchasers should not rely on them as statements of representation of fact, but must satisfy themselves by inspection or otherwise as to their accuracy. No person in this firm's employment has the authority to make or give any representation or warranty in respect of the property.